



Drawing to be completed

Artist Impression of The Green



## 8.0 PARKLAND



The Parkland Character Area

- An area of restored parkland provides amenity space for the residents on the edge of the middle woodland;
- A greenway including wetland attenuation runs east-west along the northern edge of the of the existing treed field boundary;
- An informal edge of buildings overlooks the greenway with longer filtered views over the park to the woodland beyond;
- Buildings following the local Surrey vernacular tradition of simple form and a more cottage scale;
- Walls are predominantly brick, with occasional render or painted brick and a mix of clay tile and slate roofs;
- Boundaries are picket fence and native hedges;
- The new north-south permissive footpath connecting the consented Phase I with the SANG and woodland and beyond continues south;
- An informal access is provided along the eastern edge to the Forest School car park, including a minibus space; and
- The northern section of the SANG circular walk runs along the edge of the park and woodland to the south.





Artist's impression of The Parkland

*\*Some of the images are illustrative impressions of the design intent and will be replaced during the course of the determination.*





Artist's impression of The Parkland Edge



MIDDLE WOODLAND & FOREST SCHOOL

- This area of woodland between the Parkland and the Southern Fields SANG will be the home for the proposed Grayswood Nursery and Forest School;
- An Outdoor Classroom will provide the school with an all year round facility;
  - The timber weather clad building, with strawbale and timber structure will have a light ‘footprint’ in its woodland setting;
  - The school is accessed via the north-south permissive footpath, leading down for the car park, and the SANG circular walk to the south; and
  - Wetland scraps follow the routes of the footpaths down to the wetland area within the southern fields SANG.

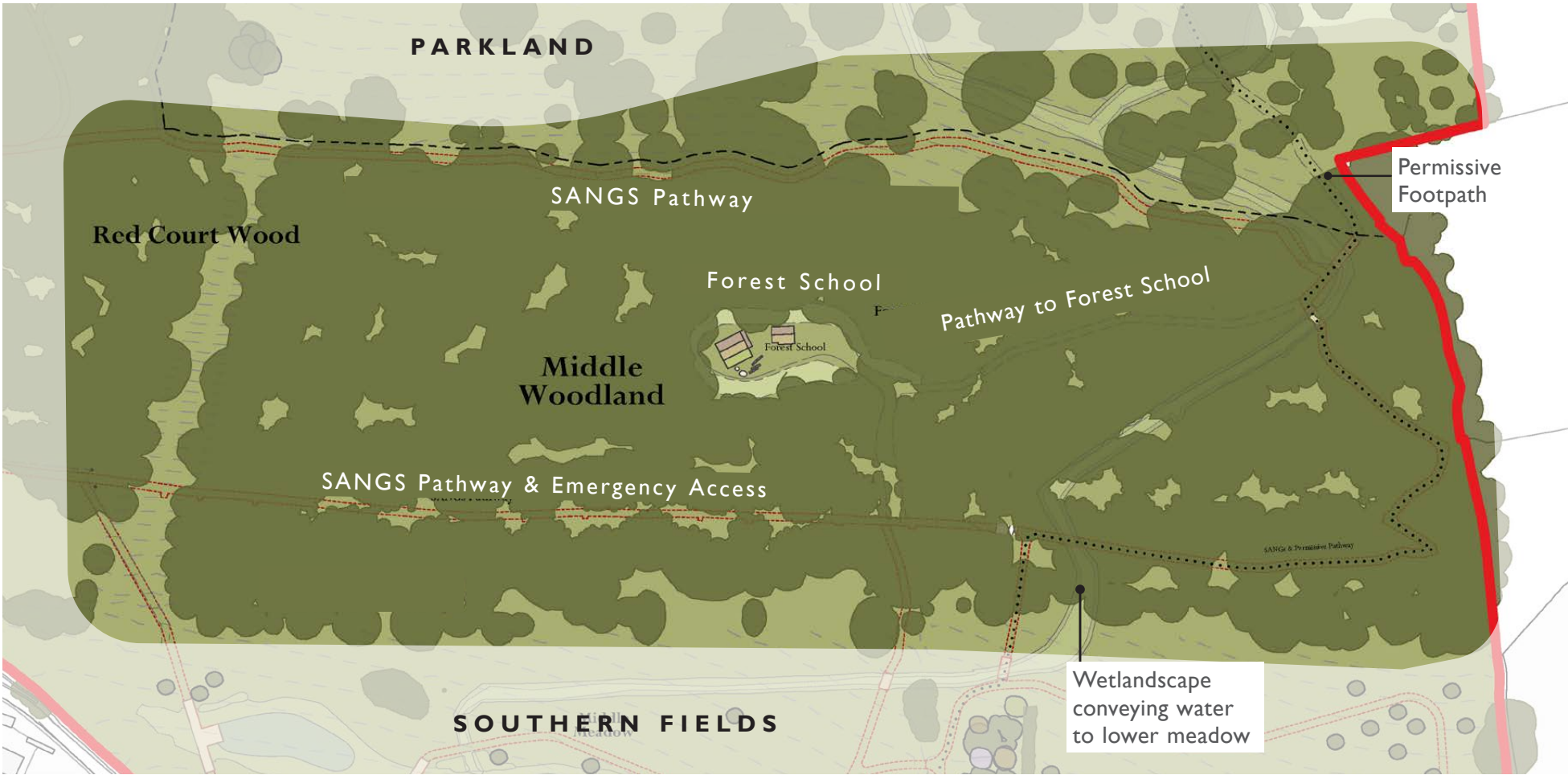

Middle Woodland Character Area



The Forest School Platform



## SOUTHERN FIELDS & SANG

- Creation of permanent ponds and wetland as a landscape feature and an educational resource for the Forest School, Scouts and visitors;
- An extension to the existing footpath FP37 along the northern side of Bell Vale Lane, connects to the southern section of the SANG circular walk and a network of routes, including boardwalks across the wetland;
- The network of routes provides a connection for walker and ramblers to the existing National Trust Black Down to the south of the site;
- The existing grassland, woodland edge and new marginal and meadow wetland and open water create a rich and diverse range of habitats; and
- The eastern meadow is retained as grassland.





CHARACTER AREAS

MIDDLE WOODLAND & SOUTHERN

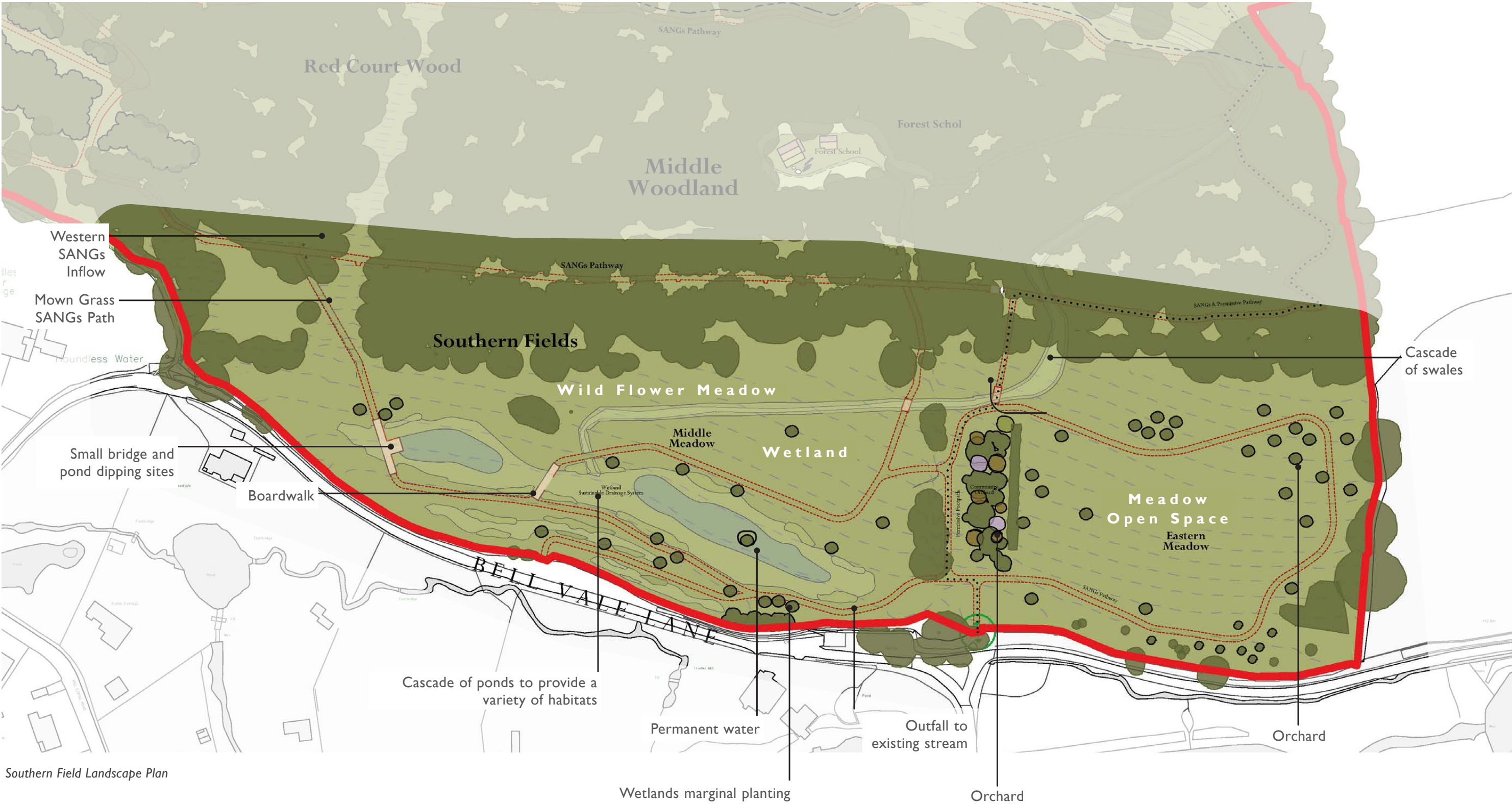





Existing Viewpoint



Proposed Verified CGI view



WESTERN WOODLAND & SCOUTS

- The broad valley running parallel to Midhurst Road extends south beyond the entrance, extending east along the edge of the Western Woodland;
- New wetland features will be designed in a low key naturalistic manner within the valley of the Western Meadow. This will be fed into the wetland areas in the southern fields SANG;
- A new headquarters for the 1st Haslemere Scout Group, which will also be used by a local nursery school will be provided within the Western Woodland. These facilities will be accessed via the residential area to the north;
- The timber weather board building with a single pitch 'green' roof, with light weight porch and small timber outbuildings sits lightly in woodland setting;
- A footpath from the new walkers car park connects to the SANG circular walk running through the woodland; and
- The existing footpath FP37 along the northern edge of the Western Meadow connects to the SANG and the new internal network and onward to the National Trust Black Down and SDNP.
- A new headquarters for the 1st Haslemere Scout Group, which will also be used by a local nursery school; and
- The new headquarters will include a Scout Hut, with associated car parking.





8.0 DETAILED DESIGN PROPOSALS

This Section sets out the details of the items relating to the Detailed Planning application. It shows how the detailed design proposals of the application relate to the wider proposals.

The site and policy analysis relating to these detailed elements are described in the previous sections and they have guided our thought process from the Vision through to the preparation of the detailed design proposals.

The Detailed Planning application seeks permission for:

- 1. a junction alteration from Midhurst Road, two dwellings, a car park, associated landscape, drainage and associated access road to serve the development (including the diversion of a public footpath);
- 2. the erection of a scout facility /nursery (Use Class F) and an education facility (Use Class F); and
- 3. Suitable Alternative Natural Greenspace (SANG).

1. JUNCTION ALTERATIONS FROM MIDHURST ROAD

Junction Alterations from Midhurst Road

It is proposed that the site will be accessed from Midhurst Road via a new priority junction with a ghosted right turn lane. The design of the priority junction has been carried out having regard to the standards that are set out within the Design Manual for Roads and Bridges (that apply to trunk road design), Manual for Streets and the advice received from the Highway Authority.

Within the site, the proposed access climbs to the north to provide access into the main part of the site. An Infrastructure Design Consultant (Motion) has prepared a technical design of the alignment of the first 400-500 metres of the site access road, from the proposed Midhurst Road junction (having regard to levels and gradients). The detailed design of the access road has been subject to an independent Road Safety Audit and is described in detail in the Transport Assessment.

The access strategy requires a minor realignment of the existing public right of way (Footpath 597) that runs along the east side of Midhurst Road. The realignment of Footpath 597 is required as the carriageway of Midhurst Road will be widened (to accommodate the right turn lane) and the existing alignment of Footpath 597 would fall within the widened carriageway (if the footpath were to remain on

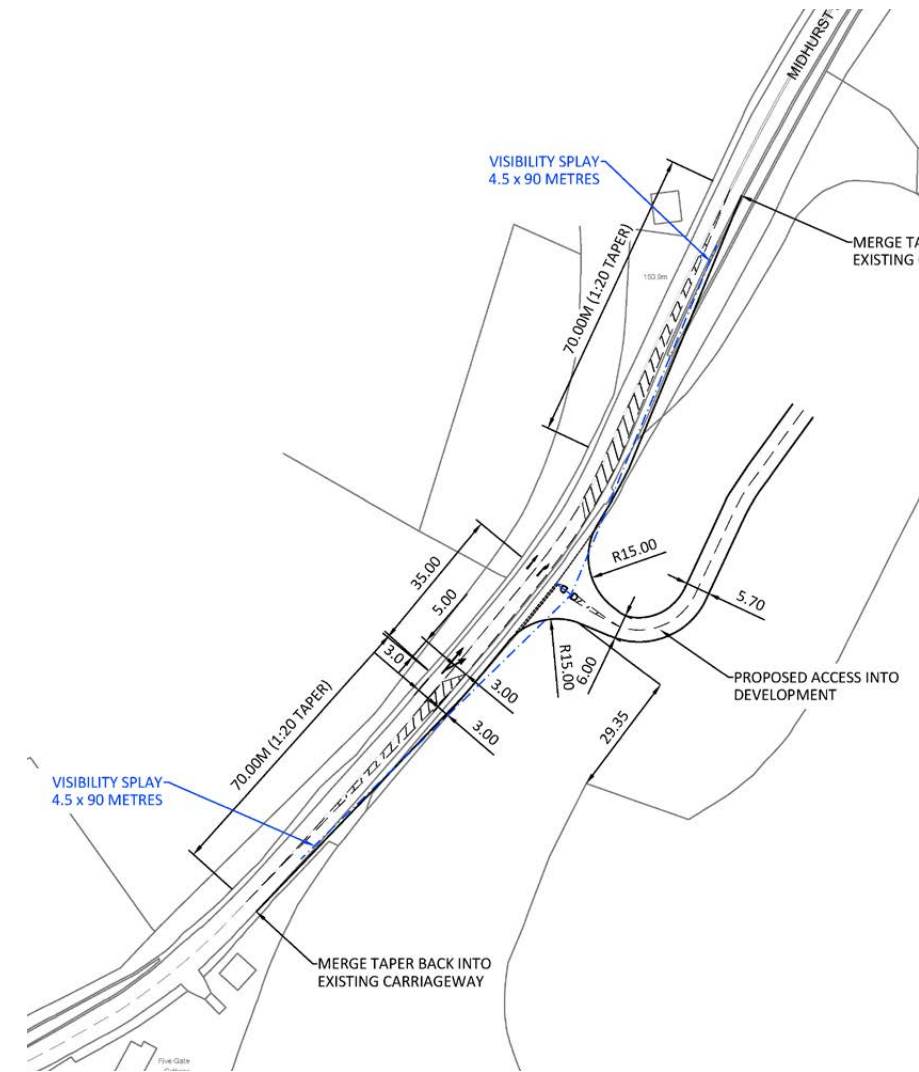

Detailed Midhurst Access Junction

its existing alignment). The realigned footpath will continue along the east side of Midhurst Road, but will be set back to accommodate the site access and right turn lane. The realigned footpath will tie into the site access and the pedestrian island, that is situated within the mouth of the access, to accommodate pedestrian movements across the site access (and along Footpath 597).

Car Park

To the north of the access from Midhurst Road a new car parking facilities for 6 cars (with room to expand by a further 6 if required) is provided for walkers and ramblers, giving access to the SDNP and Black Down Park. Designed in a simple rural style.



Detailed Midhurst Access Landscape Plan

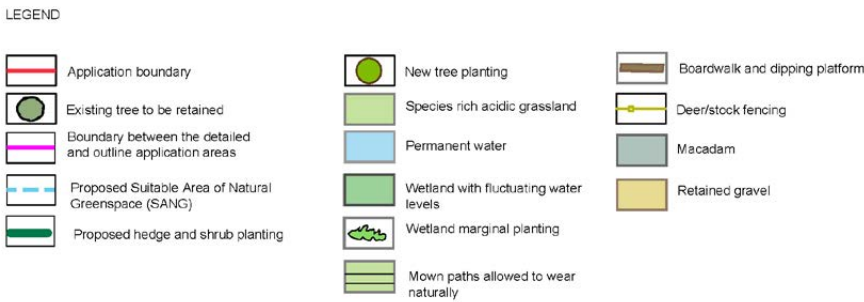





Masterplan Key



Existing Viewpoint

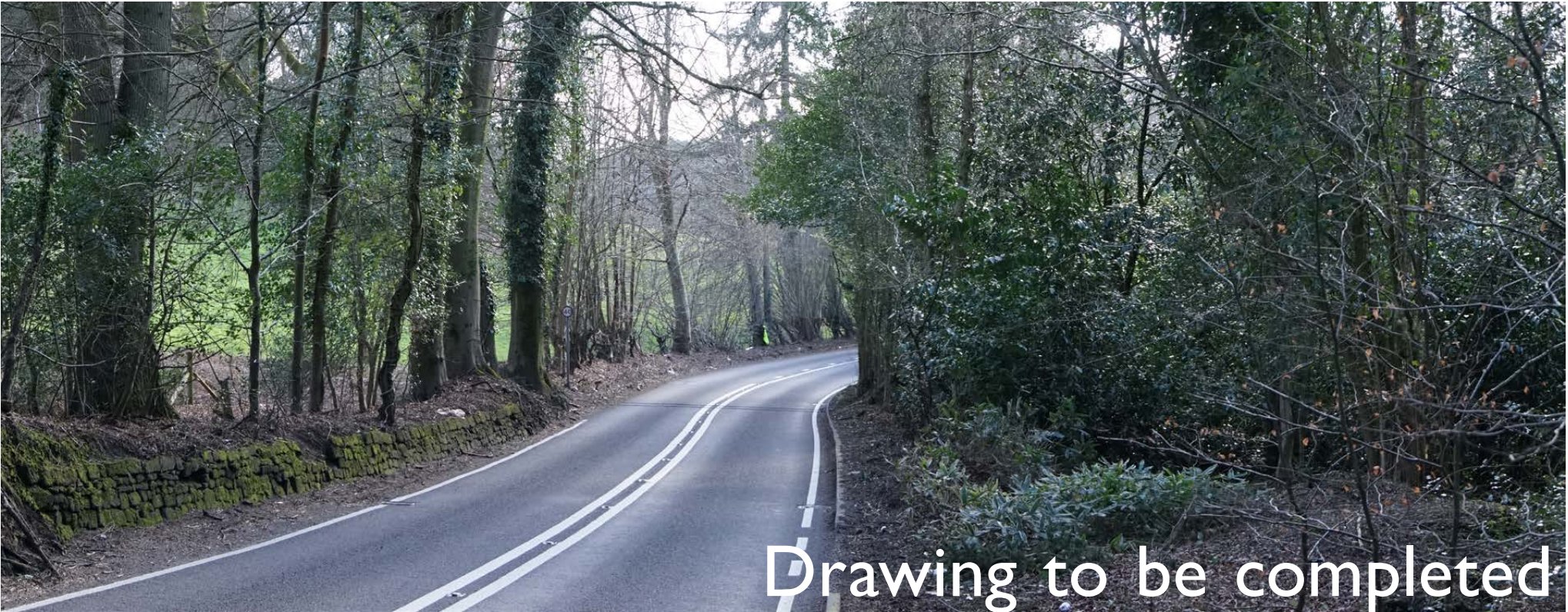

Proposed Verified CGI view

*\*Some of the images are illustrative impressions of the design intent and will be replaced by CGIs during the course of the determination.*





Masterplan Key



Existing Viewpoint



Proposed Verified CGI view

*\*Some of the images are illustrative impressions of the design intent and will be replaced by CGIs during the course of the determination.*





Masterplan Key



Existing Viewpoint



Proposed Verified CGI view

Drawing to be completed

*\*Some of the images are illustrative impressions of the design intent and will be replaced by CGIs during the course of the determination.*